

APPLICATIONS

- Grow containers
- Potted irrigation

FEATURES

- High clogging resistance
- Superb uniformity with 8 dripping outlets
- Easy to install & connect to micro-tube and placement in the container
- Surface wetting that distributes the water uniformly in the container substrate

SPECIFICATIONS

- Compatible with 5-10 gallon containers.
- Diameter: 250mm (10 inches).
- The flow from each dripping outlet is determined by the hub dripper.
- Flow of the hub dripper should be 2-8 l/h (0.43-1.76 GPH). If your flow/pressure is out of this range follow Netafim guidelines for online dripper design.
- Max operating pressure: 4.0 bar (58 PSI)

OPTIONS

- PCJ connection options to the hub dripper:
 - With barb connector (1)
 - With Press-Fit connector and elbow Press-Fit to barb connector. (2)

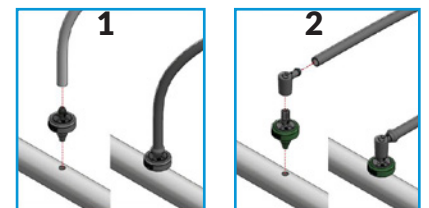

INSTALLATION INSTRUCTIONS

- Insert the 5 spikes into the 5 holes on the NetBow underside.
- Place the NetBow on the substrate surface in the pot, surrounding the plant location.
- Connect the free side of the micro-tube to the NetBow barb inlet. For NetBow with Press-Fit inlet use a straight Press-Fit to barb adaptor.
- Insert the NetBow spikes into the soil so that its underside is in contact with the soil.
- Adjust the NetBow inlet T orientation (up/down) as to allow the optimal micro-tube position.